

October 12

# PRESBYTERY OF SOUTH LOUISIANA

# 2019



9340 Florida Blvd  
Baton Rouge, Louisiana 70815  
(225) 924-4271



# Broadmoor Presbyterian Church

PRESBYTERIAN CHURCH (USA)

9340 Florida Blvd.  
Baton Rouge, LA 70815

Phone: (225) 924-4271  
Fax: (225) 924-9613

E-Mail: [bpresby@bellsouth.net](mailto:bpresby@bellsouth.net)  
Web: [www.broadmoorpresbyterian.org](http://www.broadmoorpresbyterian.org)

Dear Friends in Christ,

The staff, session and congregation of Broadmoor Presbyterian Church of Baton Rouge are delighted to host the 143<sup>rd</sup> Stated Meeting of the Presbytery of South Louisiana on Saturday, October 12<sup>th</sup>, 2019. It is such a joy for the Session and members of this congregation to welcome everyone to our campus. BPC was founded in 1958 to reach out to what was then the east side of Baton Rouge. Construction on the facilities began at a time when Florida Boulevard was just two-lane Florida Street. The congregation experienced tremendous growth in the 60s through the early 80s as the area grew and flourished, but recent decades have seen us facing many of the same challenges of mainline congregations. Nevertheless, we continue our mission of helping people "become fully devoted followers of Christ."

Included with this invitation is a map with directions to BPC, a campus map, and a list of reasonably priced hotels in the area. Registration opens at 8:00 a.m. on Saturday. Reservations for lunch are not required. Lunch tickets will be made available for a \$10 contribution on a "first-come, first-served" basis. There are also several restaurants close to the church.

Reservations *are* necessary for those requesting childcare for children who are five years and younger. Childcare cannot be provided for children who are sick or require special care. Parents must provide a sack lunch, snacks, diapers, bottles and other items as necessary. Parents should pick up their children promptly after the Presbytery meeting. Please call the church office no later than **one week** prior to the meeting to indicate number and age of the child(ren) for whom you are making reservations.

Please let the Church staff know of any equipment, meeting rooms, or display space desired. We will coordinate with making provisions. Please contact Peggy Hammond at 225-924-4271 to arrange display space at least one week prior to the meeting.

We look forward to seeing you Saturday, October 12<sup>th</sup>.

Faithfully yours,

*Barrett Ingram*

The Rev. Barrett Ingram, Pastor



# The Best Way To Get There.

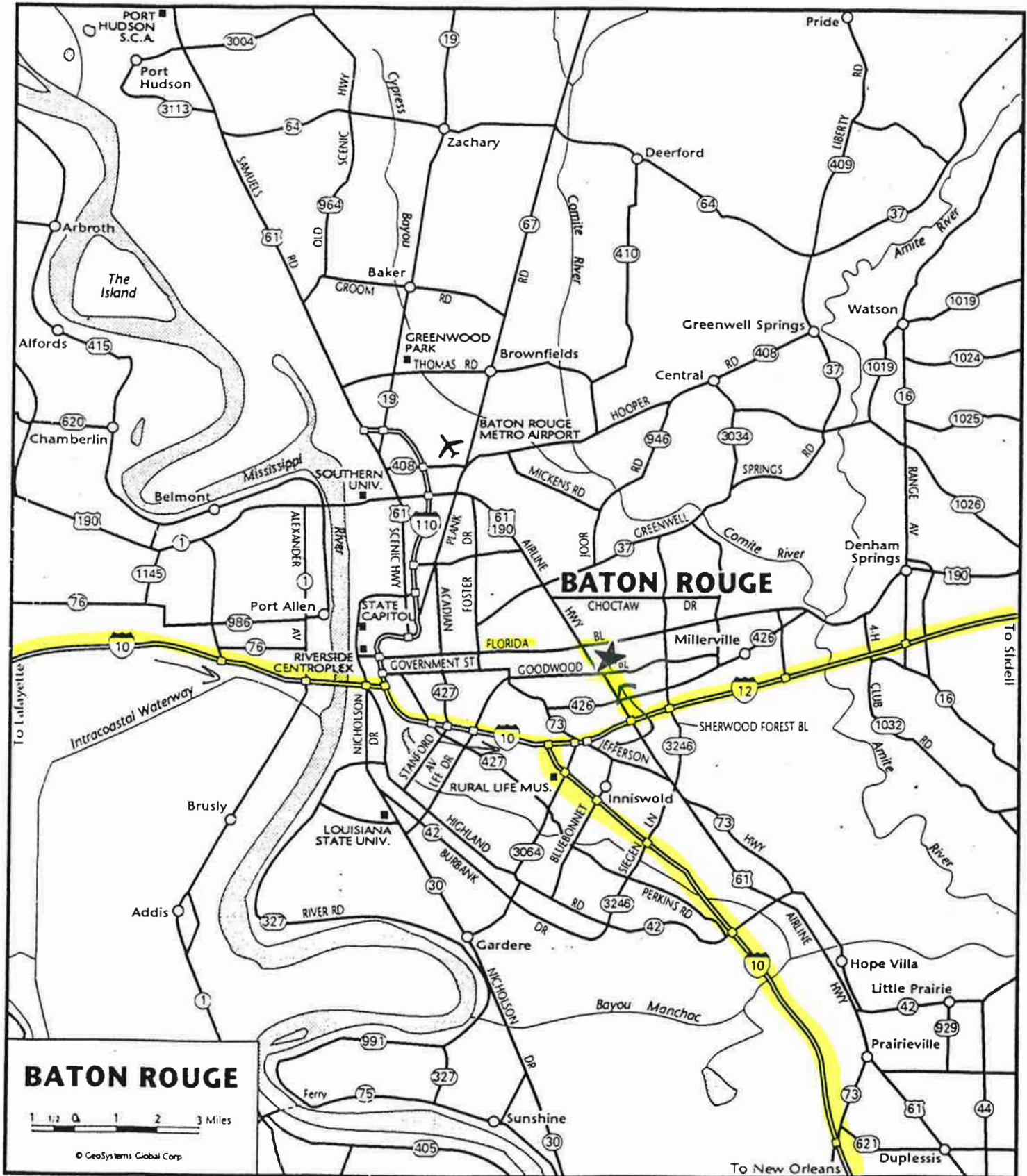

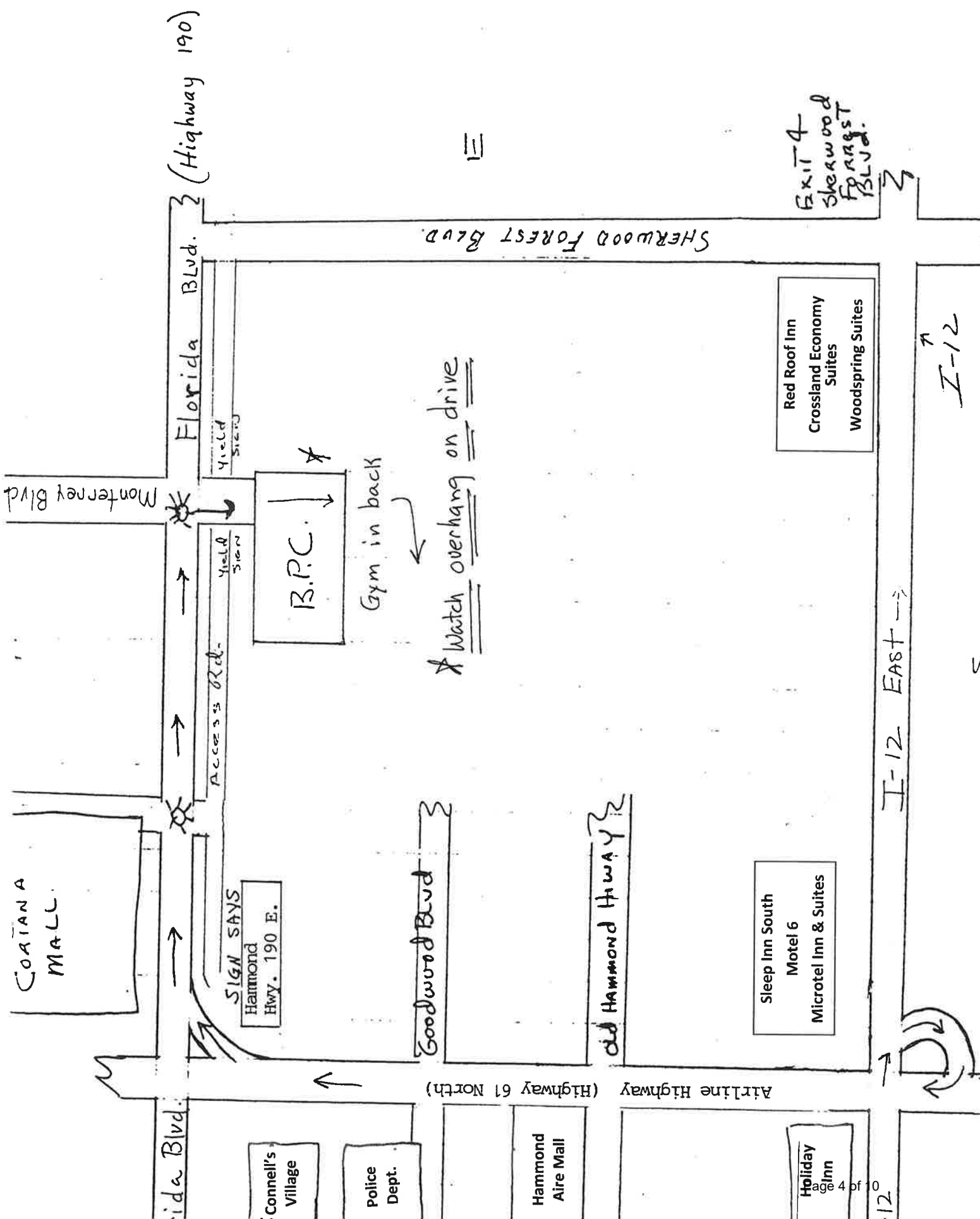

11

**I-12 Sherwood Forest Exit**

**Red Roof Inn  
11314 Boardwalk  
Baton Rouge, LA 70815  
225-275-6600**

**Crossland Economy Studios  
11140 Boardwalk  
B.R. 70815  
800-804-3724**

**Woodspring Suites, B.R. East  
11544 N. Harrells Ferry Road  
B.R. 70816  
225-226-1522**

**I-10 and I-12 (Airline Hwy)**

**Sleep Inn South  
10322 Plaza American  
B.R. 70816  
225-926-8488**

**Holiday Inn B.R. South  
9940 Airline Hwy.  
B.R. 70816  
225-924-7021**

**Motel 6  
9999 Gwenadele  
B.R. 70816  
225-925-8399**

**Microtel Inn and Suites by Wyndham  
10311 Plaza American  
B.R. 70816  
225-366-7947**



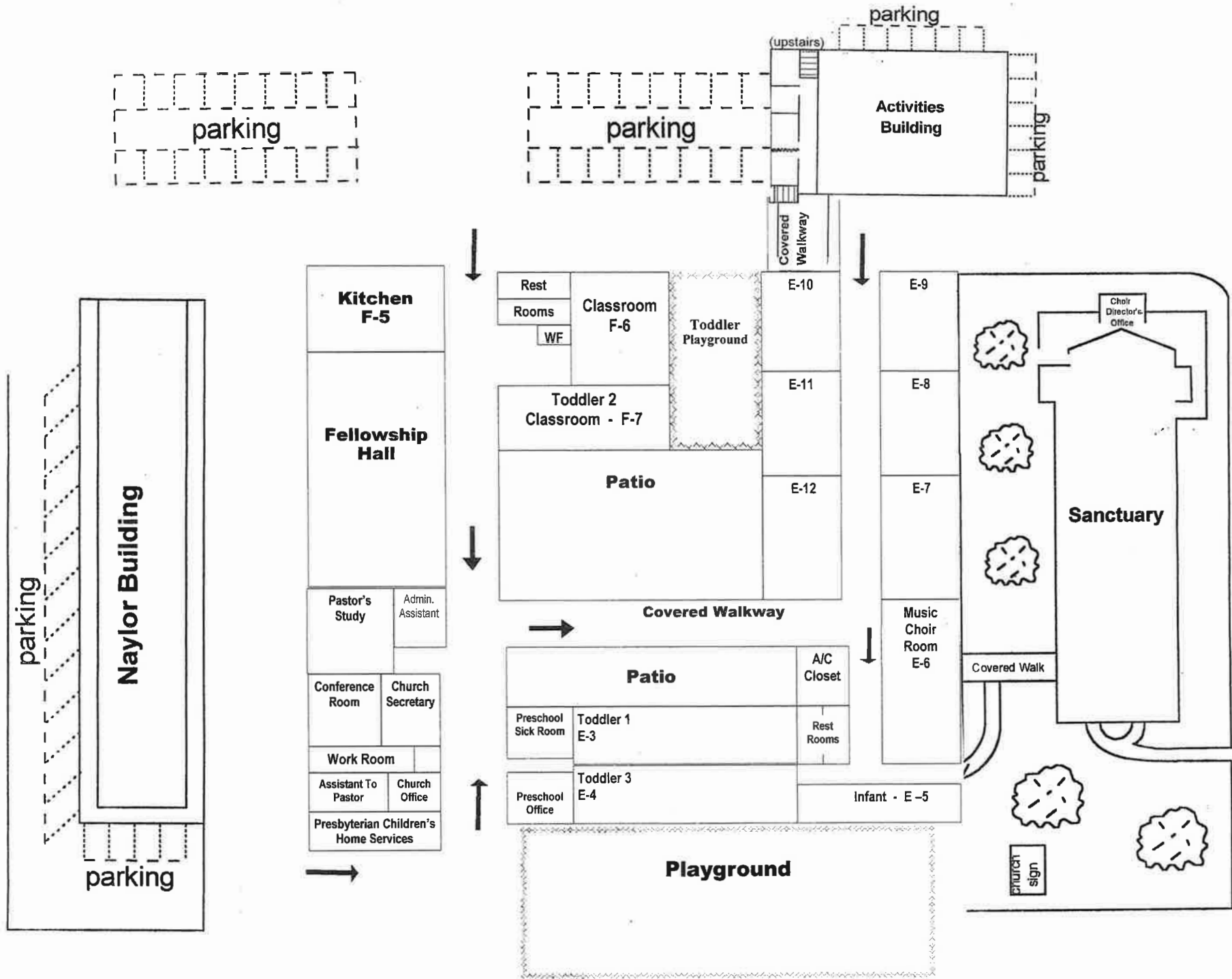

## **Meeting Information Presbytery of South Louisiana Saturday, October 12, 2019**

This packet contains the major business to be considered at the 143rd Stated Meeting of the Presbytery of South Louisiana as we seek to discern and do the will of God for God's church in South Louisiana. The meeting will be held at **Broadmoor Presbyterian Church, 9340 Florida Blvd., Baton Rouge, LA 70815**. Any reports not received in time to get them to commissioners and members of Presbytery by email prior to the October 12<sup>th</sup> meeting will be considered as new business.

**Registration** opens at 8:00 a.m. on Saturday. Registration lists will be moved to the Clerk's desk after lunch. Late comers must register there, and those desiring to leave early should present a written request for excuse to the Clerk.

**Display Space** may be secured by calling **Broadmoor Presbyterian Church, phone: 225-924-4271**.

**Voting Members of Presbytery**: The membership of the Presbytery consists of those Teaching Elders called through the Presbytery and those Ruling Elders commissioned by the Sessions of its constituent churches. (Book of Order) In addition, Elders who are elected officers or professional staff of Presbytery, or chairpersons of Presbytery committees, or Commissioned Lay Pastors, or the Recording Clerk, or the Parliamentarian, or the Moderator of Presbyterian Women shall be a member of Presbytery with voice and vote. Certified Christian Educators may be given vote in Presbytery meetings, during the time of their service.

**Those Who May Be Given Permission To Speak At Presbytery**: Elected officers or professional staff of Presbytery, or chairpersons of Presbytery committees, or the Moderator of Presbyterian Women, who are not Elders, or past Moderators of the Presbytery of South Louisiana and Certified Christian Educators shall have the privilege of the floor at meetings of Presbytery. Official representatives of other presbyteries or higher governing bodies who are present, Christian Educators who are not certified, and any Minister of another presbytery who is serving in the Presbytery of South Louisiana as a stated supply or interim pastor of any of our congregations, plus any other Minister of the Word and Sacrament who is seated as a corresponding member may be given permission to speak. (Permission may be requested by a commissioner to Presbytery.) This group may not make a motion or vote, but may enter into debate.

**Those Expected To Attend Presbytery** are Elders elected by their Session and Minister members. Honorably retired teaching elders who are not serving a congregation, teaching elders who are infirm, military chaplains on assignment outside the bounds of Presbytery, minister members who have been approved to do study outside of bounds, and teaching elders who have approval to labor outside of bounds, shall all be excused from meetings of Presbytery. However, all other active members of Presbytery who are in good health shall be expected to attend meetings of Presbytery and participate in all other ways as active members.

**If You Must Leave Before The Meeting Ends**: Any Minister or Elder who must retire from the meeting prior to the stated time for adjournment should present a request for excuse in writing to the Clerk in order to be excused.

**Lunch and Refreshments**: \$10 per person charge for continental breakfast, lunch and snacks.

**Child Care**: Child care will be provided at the Presbytery meeting. You may call **Broadmoor Presbyterian Church, phone: 225-924-4271** to reserve space for your child/children at this meeting.

## PARLIAMENTARY PROCEDURE

### ***Meetings of the Presbytery of South Louisiana***

1. Any main motion introduced on the floor should be written legibly and given to the Stated Clerk.
2. Microphones are placed on the floor for commissioners to use. Find your nearest mike and go to it promptly whenever you wish to address the Presbytery.
3. The proper procedure is to say, "Mr. Moderator," or "Madame Moderator," and wait for the Moderator to recognize you before speaking.
4. The person making the motion is entitled to speak first in debate, after the motion has been seconded and has been stated by the Moderator, providing the motion is debatable.
5. The newest edition of *Robert's Rules of Order* is the parliamentary authority.
6. At times the Moderator may rule on a matter without taking a vote. If there is no objection, it will be considered unanimous (or general) consent. If there is an objection, it should be made known immediately. If even one objects, a vote must be taken.
7. If you want to make or change a motion or policy and do not know the correct procedure:
  - 1) Get recognized by the Moderator;
  - 2) Say what you want to do;
  - 3) Ask the Moderator how to do it.

The Moderator is there to help Presbytery accomplish what it wishes to accomplish.

### TIPS ON PARLIAMENTARY PROCEDURE

TO DO THIS:	SAY THIS:	VOTE REQUIRED TO PASS:
Make a main motion.	"I move that..." or "I move to..."	Majority.
Modify or change a motion.	"I move to amend by..."	Majority.
Postpone consideration to another time.	"I move to postpone until..."	Majority; or 2/3 if made a Special Order.
End debate and bring to a vote.	"I move the previous question" or "I move the previous question on all pending questions."	2/3. Must be rising vote.
Refer to committee.	"I move that this matter be referred to..."	Majority.
Object to procedures.	"Point of order."	Usually the Moderator decides.
Challenge ruling of the Moderator.	"I appeal the Moderator's decision."	Majority or tie vote sustains the Moderator.
Retake the vote by rising.	"I call for a division" or simply "Division."	This demand requires a rising vote.

(The Moderator does not have to have the vote counted. If the vote is not counted and you desire that it be counted, you may move the incidental motion — "I move that the vote be counted.")



## EVALUATION OF PRESBYTERY MEETING October 12, 2019

*Please complete and leave on the Stated Clerk's desk or  
fill out online @ [www.pbysouthla.org](http://www.pbysouthla.org)*

Typically, Presbytery meetings have been occasions for transacting ecclesiastical business, fellowship, promotion of program, worship, and celebration. Please help us make our meeting better by sharing your observations and opinions with us.

### 1. BUSINESS:

Was there sufficient time for transacting the business of the Presbytery? Yes\_\_\_\_\_ No\_\_\_\_\_

Was the business transacted worth the effort? Yes\_\_\_\_\_ No\_\_\_\_\_

Suggestions for improvement:

### 2. PROCESS:

Was the parliamentary process: understandable\_\_\_\_\_, expediting\_\_\_\_\_, too businesslike\_\_\_\_\_,  
a game\_\_\_\_\_, other\_\_\_\_\_.

Suggestions for improving our process:

### 3. WORSHIP AND THEME:

Describe your impression of the worship:

### 4. FELLOWSHIP:

Was sufficient time or occasion provided for fellowship? Yes\_\_\_\_\_ No\_\_\_\_\_

If no, would you welcome more time for fellowship? Yes\_\_\_\_\_ No\_\_\_\_\_

### 5. FACILITIES AND MEAL:

Were the facilities adequate for this meeting? Yes\_\_\_\_\_ No\_\_\_\_\_

Was the meal OK? Yes\_\_\_\_\_ No\_\_\_\_\_

Comments:

### 6. DISPLAYS:

Would you welcome fewer displays? Yes\_\_\_\_\_ No\_\_\_\_\_

Would you welcome a few reports from the program committees during the business sessions of the Presbytery meeting? Yes\_\_\_\_\_ No\_\_\_\_\_

Comments:

### 7. GENERAL IMPRESSIONS:

Comments:

On the following scale, please rate this meeting: Not Satisfied \_\_\_\_\_ Satisfied  
(circle one) 1 2 3 4 5

## MOTION PRESENTATION BLANK

(ALL MOTIONS MUST BE PRESENTED IN WRITING. To assist in presenting motions, use this blank. Write out your motion and be prepared to hand it promptly to the Clerk or the Moderator.)

**I MOVE:**

**MOTION NO.** \_\_\_\_\_

---

---

---

---

---

ACTION: Amended Tabled  
          Adopted Withdrawn  
          Lost Referred

MAKER: \_\_\_\_\_

SECOND: \_\_\_\_\_

\*\*\*\*\*

### REQUEST FOR EXCUSE

**RETURN TO: Stated Clerk**

**Presbytery of South Louisiana  
12909 Old Hammond Highway  
Baton Rouge, LA 70816**

Date of Meeting Excuse Requested for: \_\_\_\_\_

NAME: \_\_\_\_\_

CHURCH: \_\_\_\_\_ CITY/TOWN: \_\_\_\_\_

PLEASE EXCUSE ME FOR:

\_\_\_\_\_ The Entire Meeting      \_\_\_\_\_ Morning Session      \_\_\_\_\_ Afternoon Session

\_\_\_\_\_ For the Hours \_\_\_\_\_ to \_\_\_\_\_

I NEED TO BE EXCUSED BECAUSE:

---

---

---

---

SIGNED: \_\_\_\_\_ DATE SIGNED: \_\_\_\_\_

**ALL REQUESTS FOR EXCUSE MUST BE SUBMITTED IN WRITING  
WITHIN 15 DAYS FOLLOWING EACH PRESBYTERY MEETING**